

WOOD DOWELS

Manufactured from High-Quality Beech & Birch

Raw Dowels

Our raw dowels come in both beech or birch and are both sourced from Grade-A European woods. Our dowels are individually calibrated and are 100% sorted in Germany through an automated inspection process. Our dowels are 8.15mm diameter with a tolerance of +/- 0.005" (0.15mm) assuring a precision fit. When used with wood glue, Birch Wood Dowels have a 38% higher pull-out or breaking strength than our standard multi-grooved beech dowel. During installation, when glue is added, the compressed wood fibers expand to create one of the strongest dowel joints possible.

Pre-Glued Dowels

Our pre-glued dowels are only available in Beech and are coated only with US made water-based adhesives. Extraction tests are performed here at PMI before distribution with an average extraction force of between 375-480 lbs.



RAW WOOD DOWELS

Wood Type	Item No.	Diameter	Length	Packed (Per Bag)
Beech	08.7850.6x25	6mm	25mm	21,600
Beech	08.7850.6x30	6mm	30mm	18,000
Beech	08.7850.8x30	8mm	30mm	10,000
Beech	08.7850.8x35	8mm	35mm	8,420
Beech	08.7850.8x50	8mm	50mm	6,000
Birch	08.7870.8x30	8mm	30mm	10,000

PRE-GLUED WOOD DOWEL

Wood Type	Item No.	Diameter	Length	Packed (Per Bag)
Beech	08.7860.8x30	8mm	30mm	8,000
Beech	08.7860.8x35	8mm	35mm	7,000

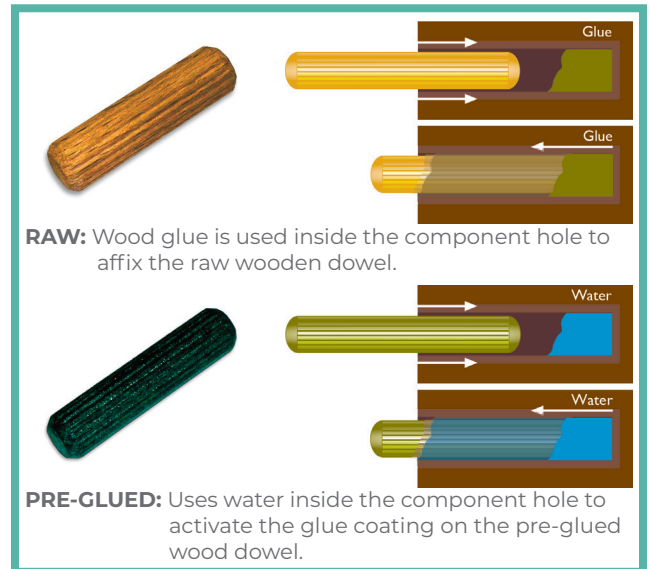

BIRCH WOOD DOWEL

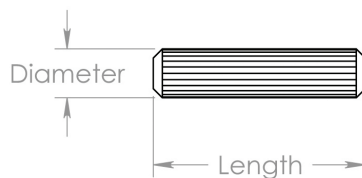

Our Beech Wood Dowels are pre-glued domestically.

AVAILABLE NOW
1-800-222-6941

e. orders@petermeier.com
w. petermeier.com
a. 1255 South Park Dr.
Kernersville, NC 27284, USA

